

# HOWARD ELEMENTARY

## BEHIND THE DESIGN OF THE TECHNOLOGY IMMERSION SCHOOL

With ample classrooms and common spaces, the new school will provide a robust learning environment to help students reach their potential. Supported by a 2013 bond, Howard is the first of four 4J schools that replace aging and inefficient facilities. The state-of-the-art, energy-efficient learning center will provide safe, sustainable, and inspiring spaces that will cost less to operate and serve our community for decades.



### Gym / Cafeteria and Community Space

- Provides space for a music room, gym, community gatherings, and cafeteria
- Can be partitioned off for after-school use by the community
- Glass tiles that adorn the wall were designed and fabricated by Howard students
- Abundance of windows and large bay doors allow for daylight and fresh air to permeate the areas



### Media Center

- The core of the school, designed to be open and connect with the different “neighborhood” wings of the school
- Connects to courtyards which allows for natural light to flow into the space
- Is flexible to provide room for books, technology, gatherings, and presentations
- Has kid-sized reading nooks and a small performance space

*“Imagine a classroom with the sky for a ceiling and the earth as a floor...”*  
 —Kirk Meyer, Boston Schoolyard Initiative



### Courtyards

- Outdoor learning spaces let students connect with outside world
- Provides the opportunity to study natural and human-created characteristics as well as see how human activities affect the environment
- Rainwater is collected from the site and used to irrigate the gardens and to flush the toilets

### School Facts

- \$22.3 million 83,600 SF
- 400+ students with capacity for 600

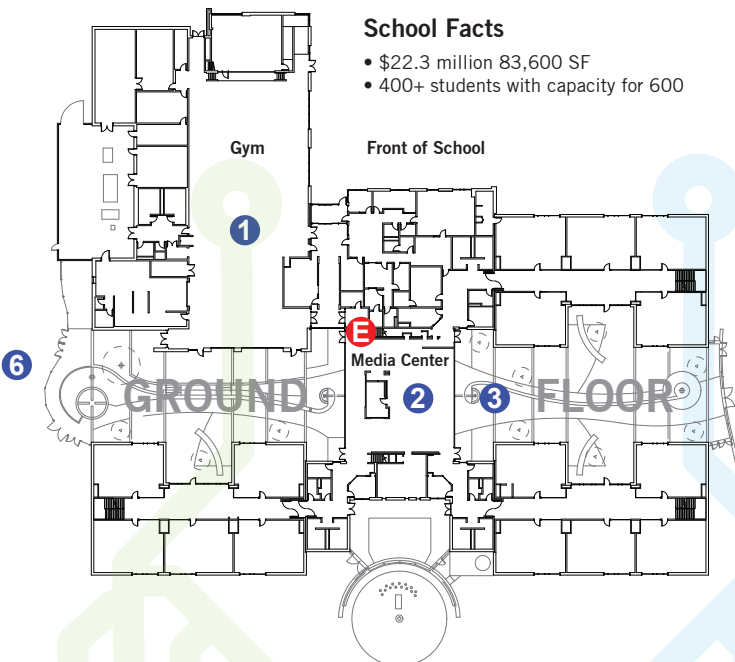



## Classroom Learning Environments

4

- Designed with contemporary teaching and learning strategies in mind
- Incorporates skylights and glass walls allowing natural light to penetrate into classrooms and hallways
- Views give staff the ability to monitor surroundings
- Common areas in the hallways allow for small-group instruction

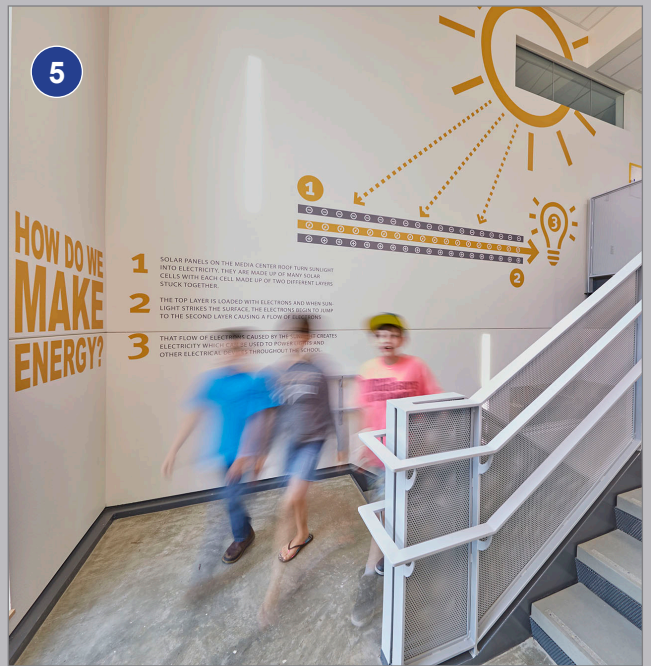

## Technology and Environmental Quality

- Classrooms are equipped with touch-screen projectors
- Integrated technology allows for zoned and school-wide intercom and video broadcasting
- Thermal comfort is an important aspect of creating exceptional indoor environmental quality and a comfortable learning environment
- Fresh air is essential to health, comfort, wellbeing, and learning. Excellent indoor air quality was the goal when selecting materials and designing mechanical systems.

## Physical Activity and Play

6

- Playground is supplied with all new equipment
- The replacement track and field between Kelly Middle School and Howard serves the community and the schools

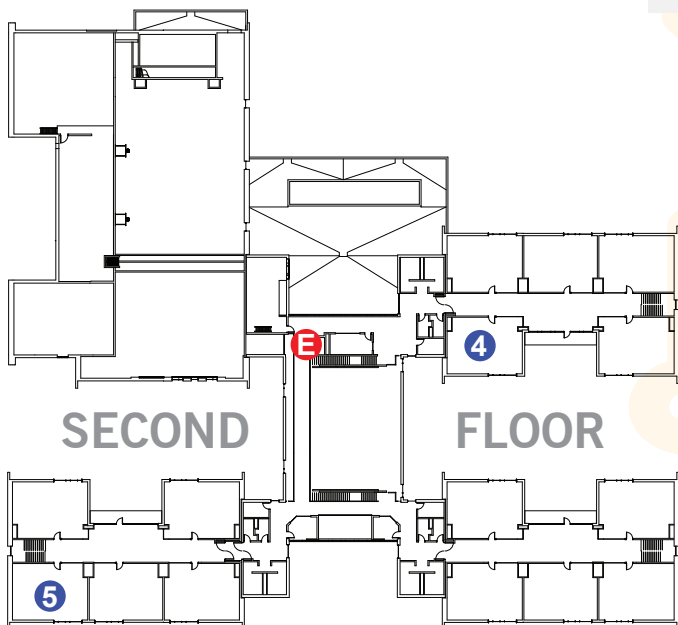

## The Howard Elementary Design Team

- **Architecture:** DOWA-IBI Group & PIVOT Architecture
- **Mechanical / Electrical / Plumbing:** PAE
- **Civil Engineering:** BHEGroup
- **Landscape Architecture:** Cameron McCarthy
- **Structural Engineering:** Hobach-Lewin Inc.
- **Security and Technology:** Northwest Information Systems
- **Food Service:** Halliday Associated
- **Traffic Engineering:** Sandow Engineering
- **Cost Estimating:** ACC Consulting
- **Graphic Design:** Oslund Design
- **Construction:** Todd Construction