

Eugene 4J School District

Howard Elementary School

Replacement Project

Project Status Update – November 2, 2015

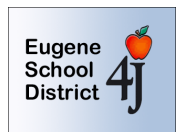

Howard – Current Site Plan

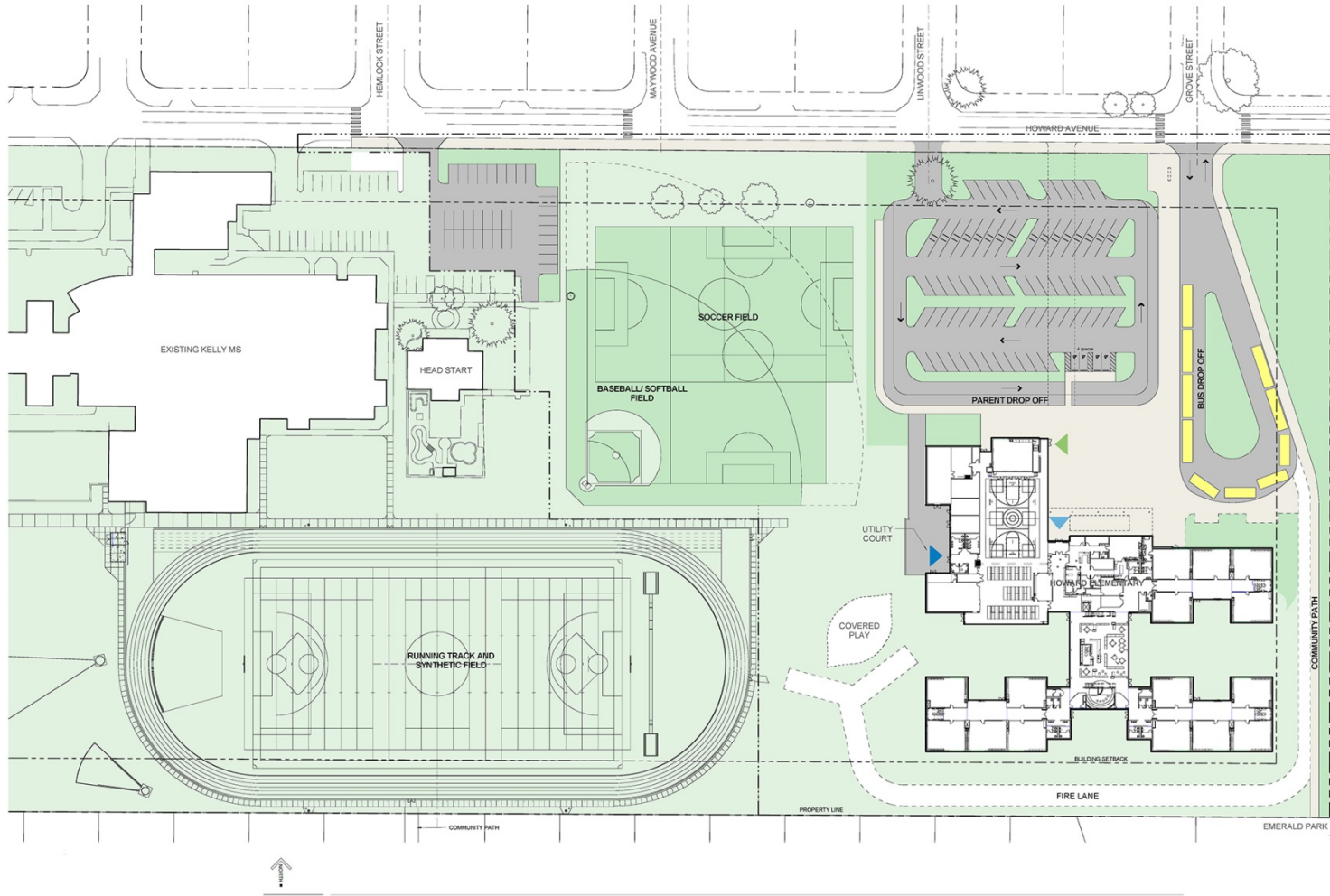

Howard – Site Learning Features

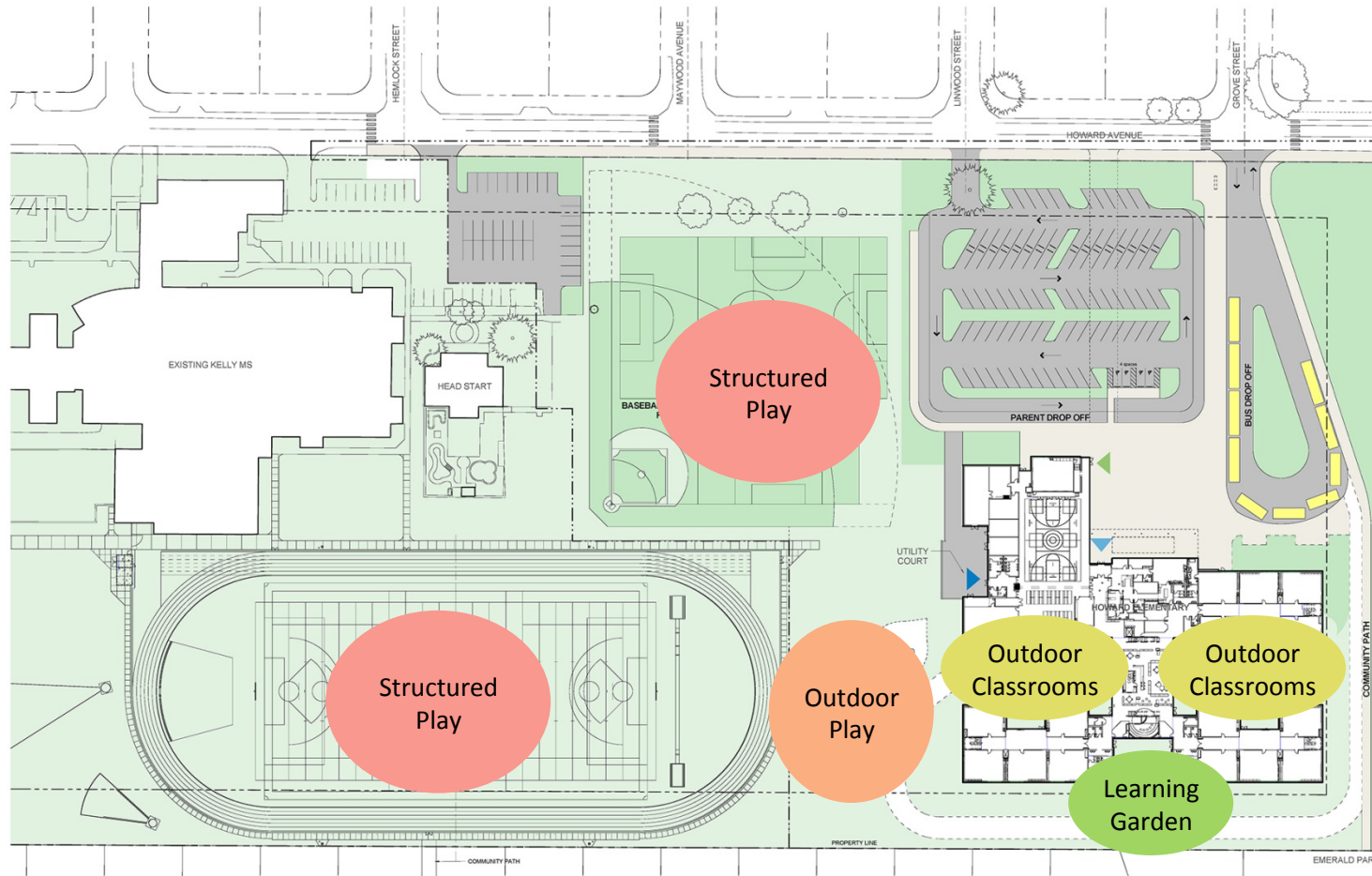

Howard – Site Sustainable Features

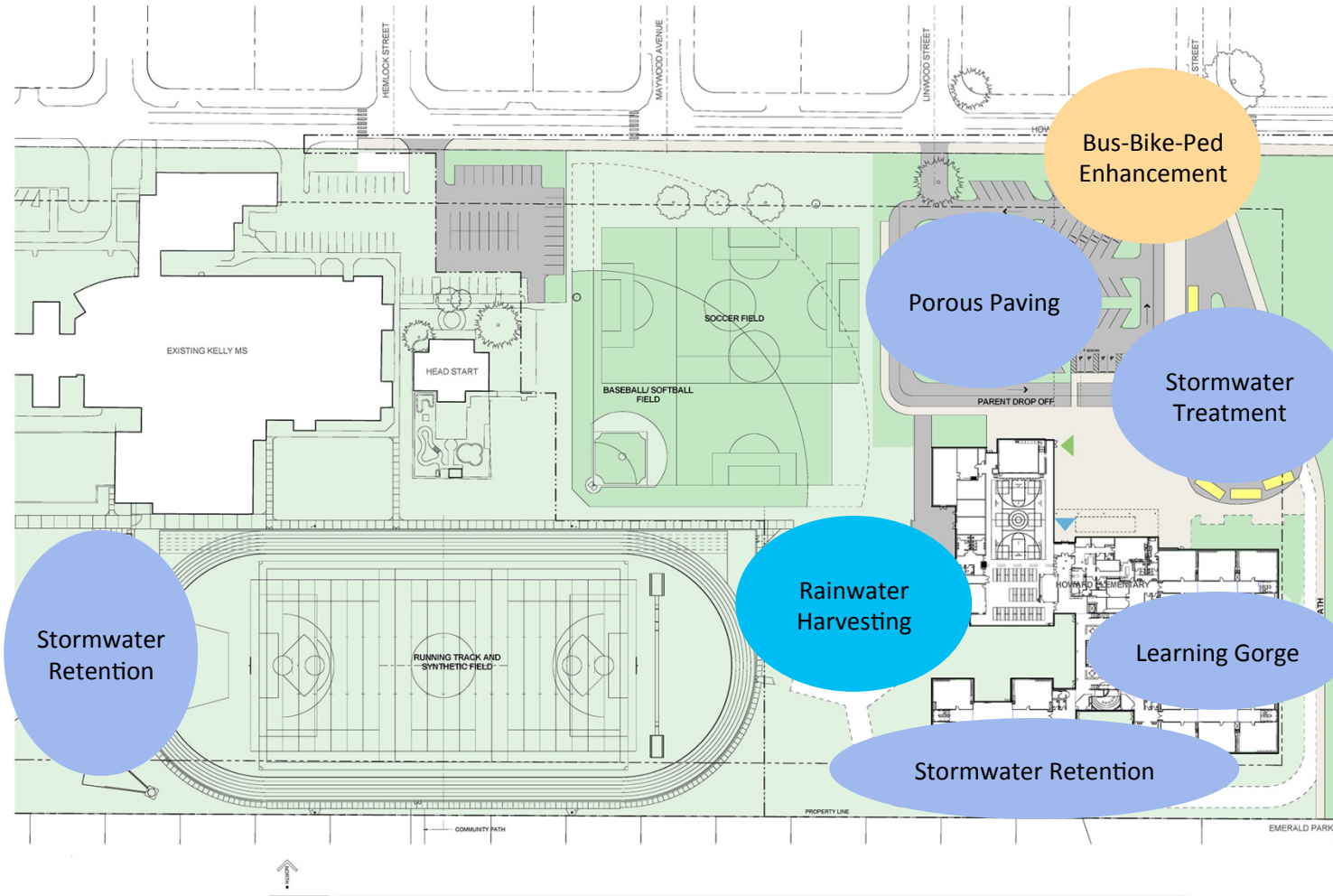

Howard – Current First Floor Plan

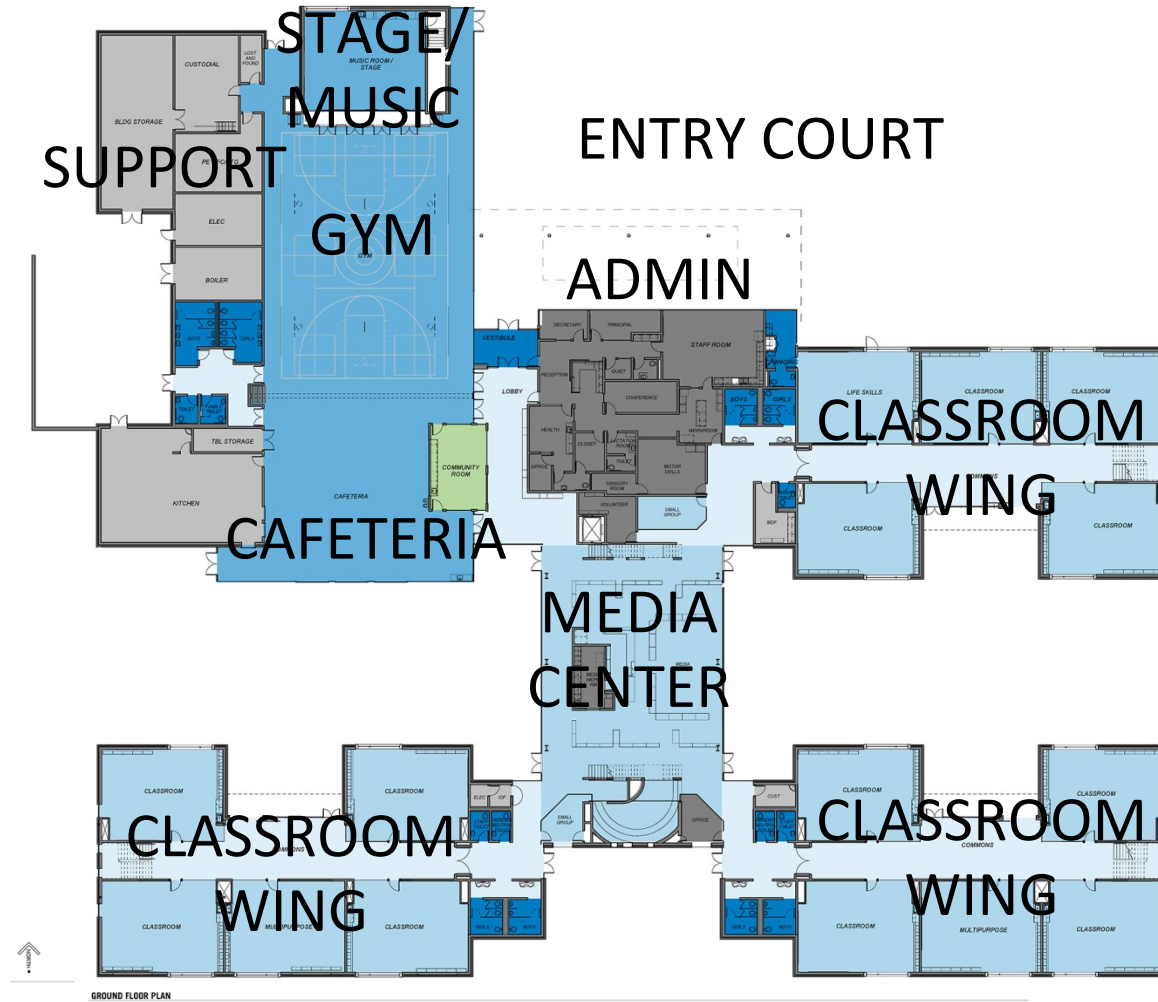

Howard – Current Second Floor Plan

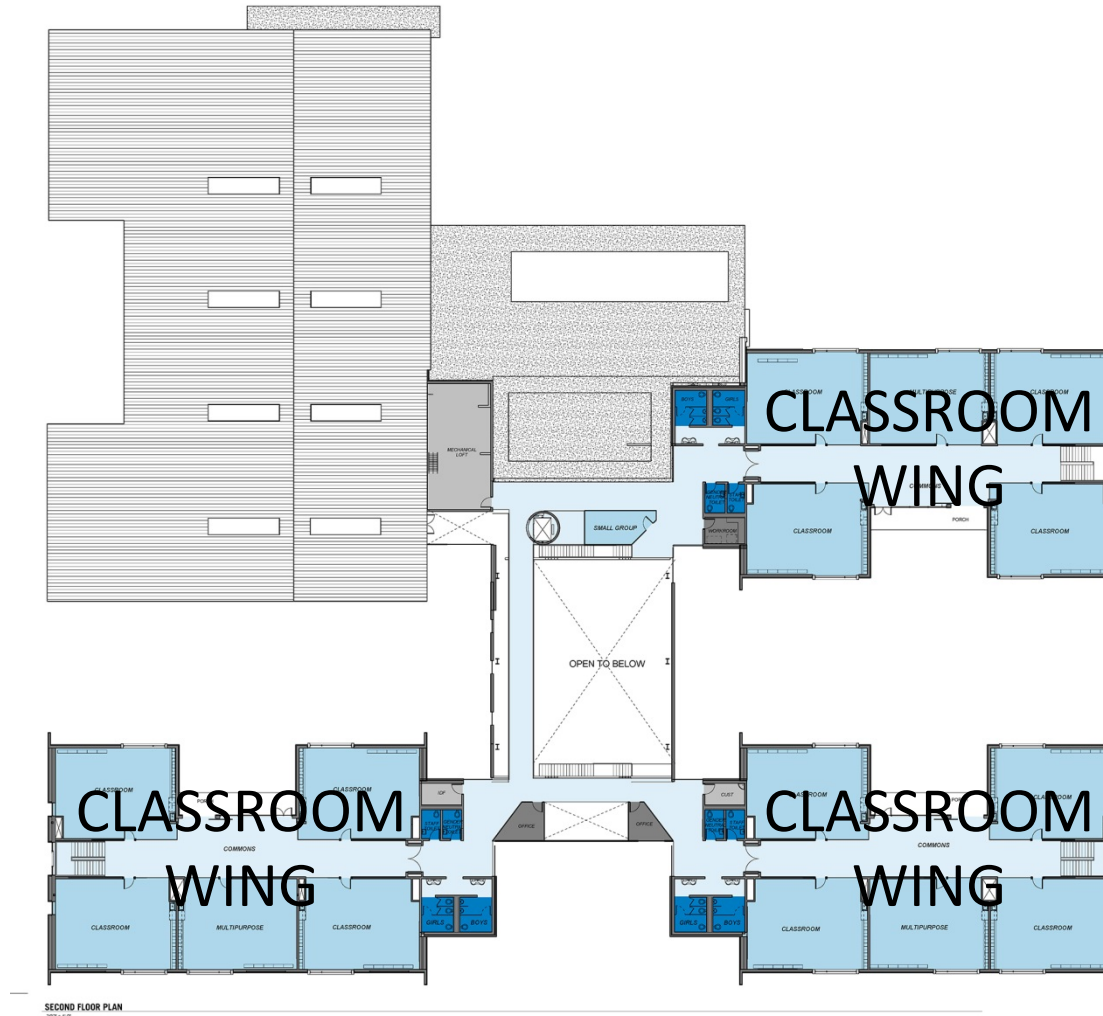

Howard – Floor Plan Learning Features

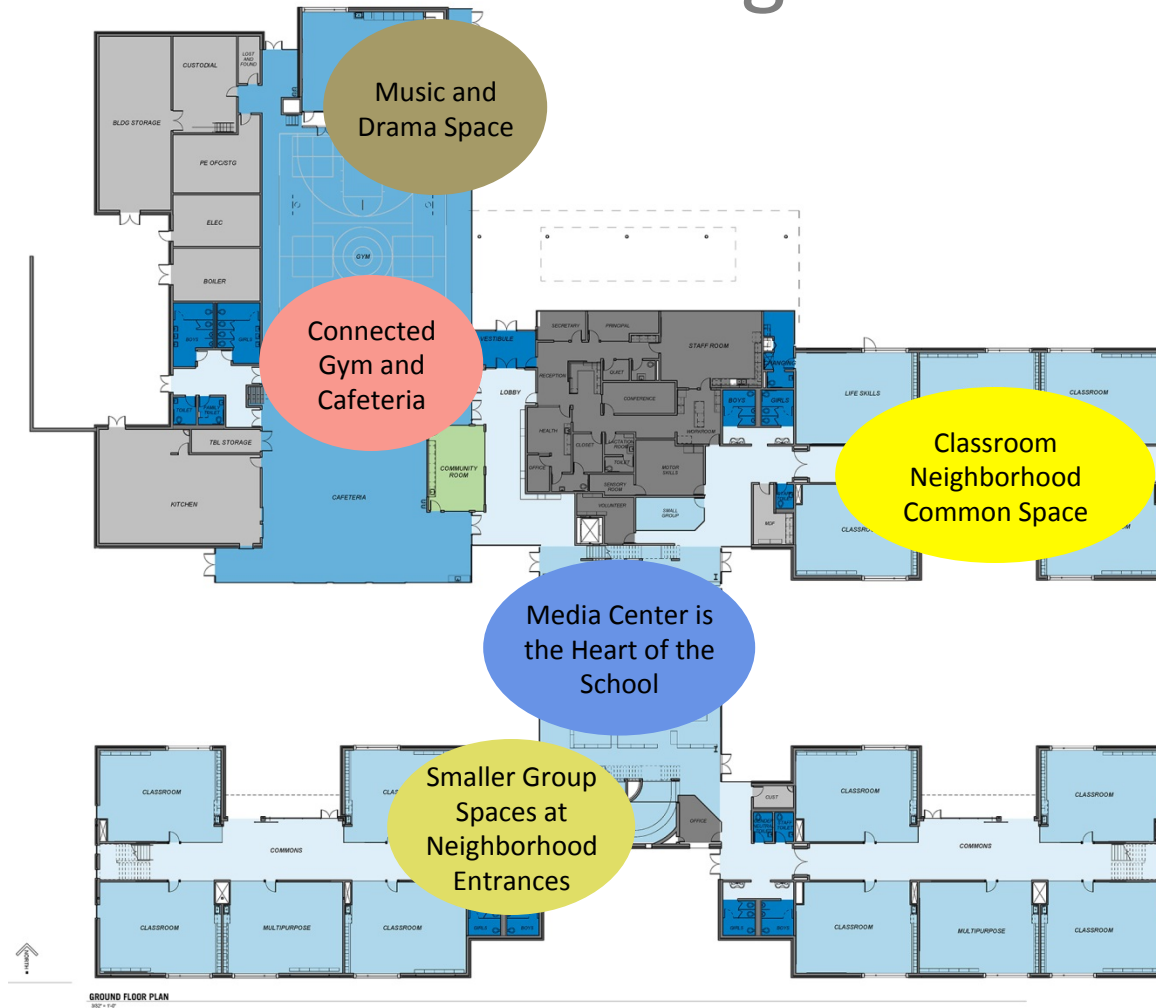

Howard – Building Sustainability Features



45% More Energy Efficient than Typical School

Water Efficient Fixtures

Daylight and LED Lighting – Energy Savings

Healthy Indoor Air Quality

PV Array on Media Center Roof

Energy Dashboard – Sustainability as a Learning Tool

Renewable, Recyclable Building Materials

Locally Sourced Materials

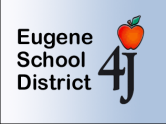

Howard – Aerial View



Howard – Construction Progress



Classroom wing B



Classroom wing C

Howard – Construction Progress



Interior view of Gym



Interior Classroom wing C

Honoring the Old School



PIVOT
ARCHITECTURE



IBI
GROUP

Eugene
School
District 4J

Dedicating the New School



Howard – Construction Video

<http://www.4j.lane.edu/communications/bond/news/howard/>

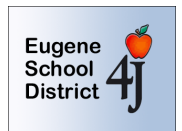

Thank you!

